

**CARING FOR FULL LAPPATO
STONEWARE SURFACES**



CARE INSTRUCTIONS FOR FULL LAPPATO STONEWARE SURFACES

Emilgroup Full Lappato ceramic surfaces are exquisite, elegant materials. To ensure that these products retain all their shine and beauty in the long term, below we provide a number of care guidelines for you to follow, after installation and initial cleaning by specialists.





Guidelines for caring for Full Lappato stoneware surfaces

Full Lappato porcelain stoneware floor coverings should always be installed by skilled professionals.

- 1** Always inspect the material for defects when the boxes are opened prior to installation. Emilceramica does not accept complaints regarding material that has already been installed, or that has been used for an application other than its intended use.

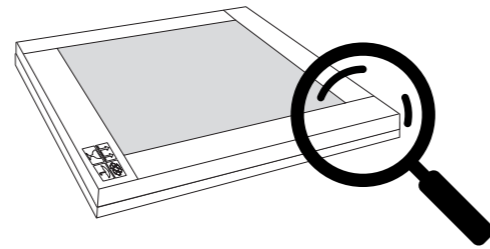

- 2** When removing tiles from their packaging, take care not to drag them over each other; handle them with care, lifting them and then placing them gently on the ground. Two people are recommended for handling sizes over 60x60 cm.

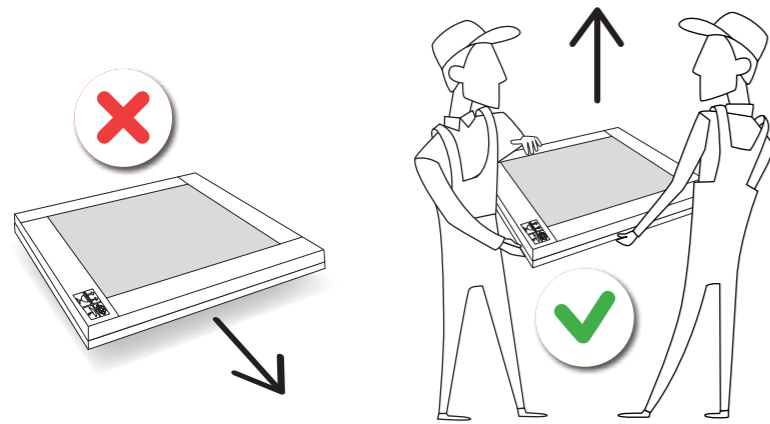

- 3** During installation, make sure that objects (boxes, furniture, building equipment) are not dragged over the floor tiles; always lift them and then place them carefully on surfaces. Any residues of sand, pebbles or other construction materials stuck to the bottoms of these items may scratch the porcelain stoneware surface.

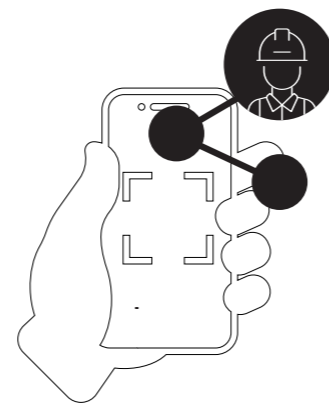
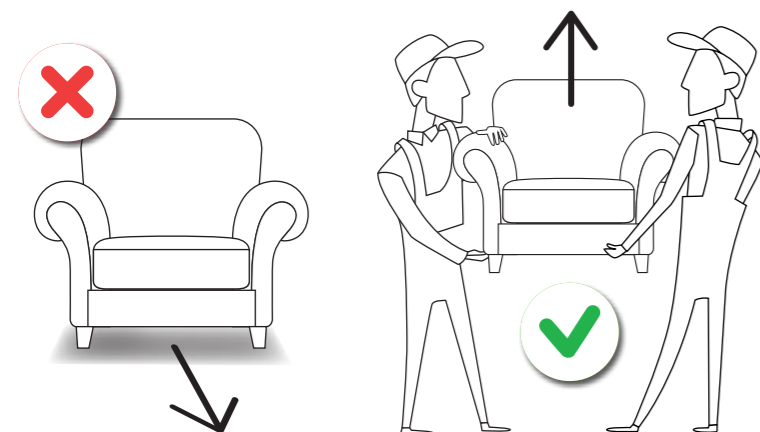

- 4** Before covering the flooring with the protective layer described above, we advise you to take photographs of the floor and share them with the director of the works.

Guidelines for caring for full lappato stoneware surfaces



- 5** During installation and protection of the floor, make sure that there are no pebbles or pieces of glass trapped in the soles of the shoes of the professional tile installers or construction workers, as they could scratch the material installed.

- 6** Make sure that the professional tile installer uses levellers with caps and guards suitable for Full Lappato porcelain stoneware, to prevent possible scratching by the presser during levelling of the covering.

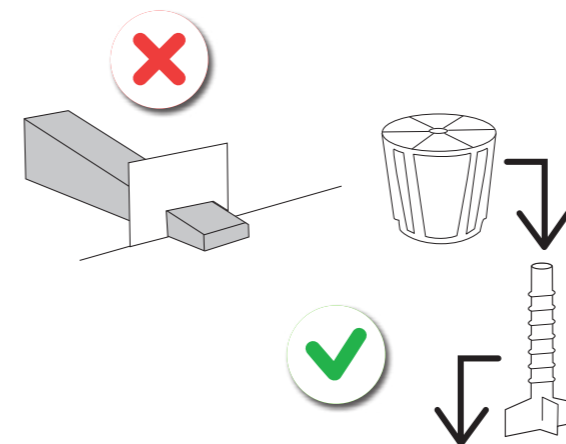

- 7** If the Full Lappato material is installed on the ground floor with direct access to outdoor areas (gardens, patios, beaches, etc.), dirt barriers should be installed (doormats, indoor mats, etc.).

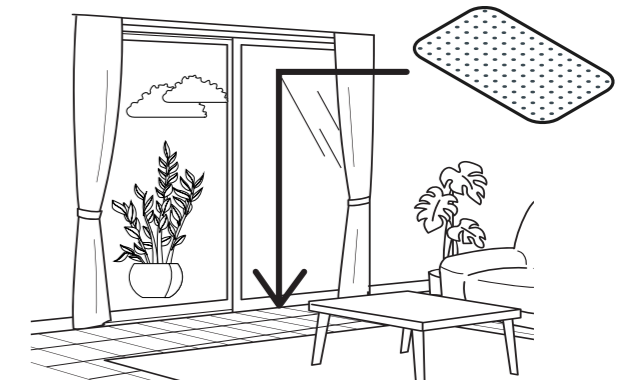

- 8** After the installation job is complete, as a further safeguard against scratches bio-adhesive rubber or felt pads should be applied under all chair legs or underneath the bases of all heavy furniture or interior design features.

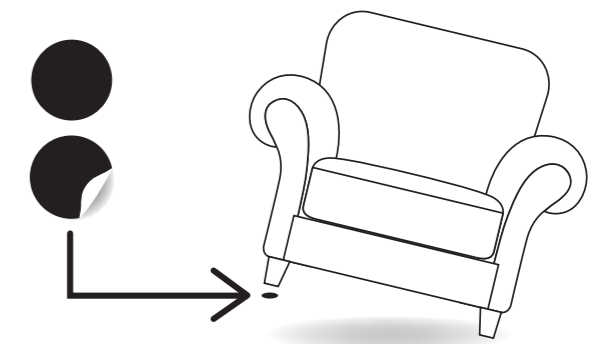

IMPORTANT

EMILCERAMICA DOES NOT GUARANTEE ITS PRODUCTS IN CASE OF FAILURE TO APPLY THESE GUIDELINES FOR CARING FOR FULL LAPPATO PORCELAIN STONEWARE SURFACES.



Initial cleaning after installation

Quick, thorough initial cleaning is of fundamental importance and is necessary on all types of ceramic floor covering to allow easy subsequent daily cleaning. In the event of the failure to carry out this procedure properly, smears may be left which make it impossible to keep the floor clean in spite of thorough routine cleaning. The floor must be washed thoroughly to remove cement and grout residues.

For cement-based grouts, clean within no more than 48 hours. For grouts containing latex or epoxy resins, cleaning must be carried out very quickly, since the components are very difficult to remove once set.

The recommended products for this type of cleaning are acid-based.

To clean, proceed as follows:

- 1 Apply the acid product diluted in a 10-20% solution to the surface.

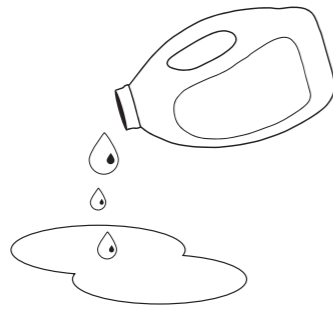

- 2 Wait 7/10 minutes.



- 3 Clean with a vigorous scrubbing action, with suitable equipment by hand, or appropriate floor cleaning appliances (floor cleaners fitted with white felt brushes are recommended; do not use black brushes which leave a carbon residue). Take care to clean the whole surface as evenly as possible.

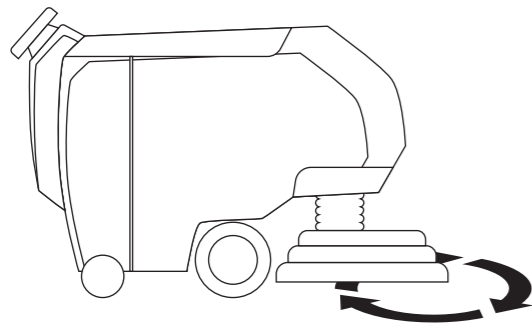

- 4 Neutralise the acid solution by washing with plenty of water, hot if possible. Keep rinsing until all acid residue has been removed.



TO AID IN THE INITIAL ACID CLEANING OPERATION, USE OF A SPECIAL VACUUM DRIER IS RECOMMENDED TO PREVENT THE WATER-ACID SOLUTION FROM DRYING; IF THE SOLUTION DRIES TO FORM A COATING OVER THE SURFACE, THE CLEANING PROCEDURE WILL HAVE FAILED.

FOR STRUCTURED PRODUCTS, WITH NOTICEABLE RELIEF PATTERNS OR ANTI-SLIP FINISHES, ACID WASHING MUST BE CARRIED OUT AS SOON AS POSSIBLE AFTER INSTALLATION. BEFORE WASHING WITH ACID, EXCESS GROUT SHOULD BE REMOVED WITH A SPONGE AND WATER DURING THE INSTALLATION PROCEDURE ITSELF.

THE WASHING OPERATION SHOULD BE TESTED ON A SPARE TILE BEFORE PROCEEDING, ESPECIALLY IN THE CASE OF SEMI-POLISHED OR POLISHED PRODUCTS.



Protecting the floor during the remainder of the construction work

After installation and cleaning, it is essential to take special care to protect the floor to prevent damage during works on the site.

The following guidelines must always be followed to protect the floor:

- 1 Vacuum / sweep the floor thoroughly to remove any residues of sand or other construction materials and anything in general which might scratch or stain it during completion of the building works.

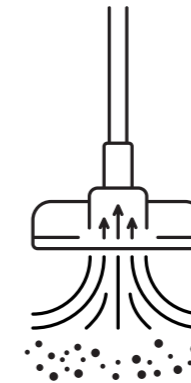

- 2 Spread a layer of felt matting or waterproof sheeting with a felt underside over the perfectly clean floor from which all dust, sand or other construction residues have been removed, covering the whole surface.

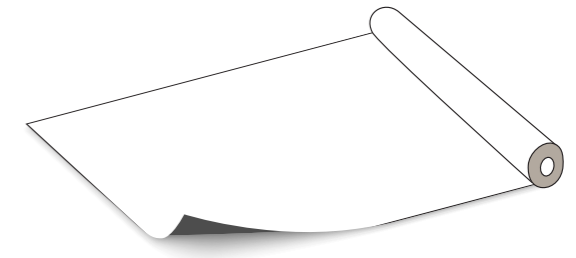

- 3 Secure the matting or sheeting with adhesive tape around the edges so that no sand or other material can get underneath the protective layer during the construction works. It is essential not to allow sand or dust to get underneath this protective layer.

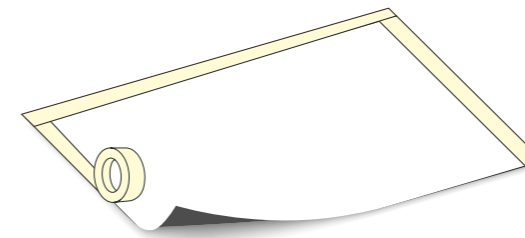

- 4 Lay an additional protective layer of corrugated cardboard on top of the felt matting or waterproof sheeting with felt underside.

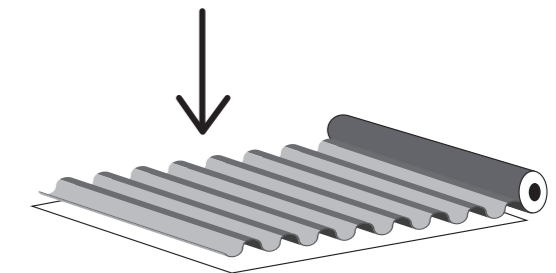

- 5 Secure the corrugated cardboard with adhesive tape around the edges so that no sand or other material can get underneath the protective layer during the construction works. It is essential not to allow sand or dust to get underneath this protective layer.

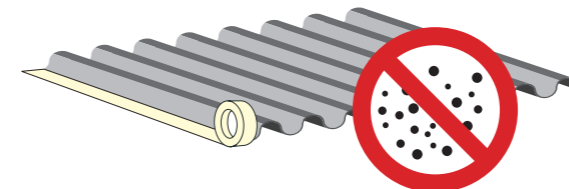

- 6 The protective layers must not be removed until the building works are complete.

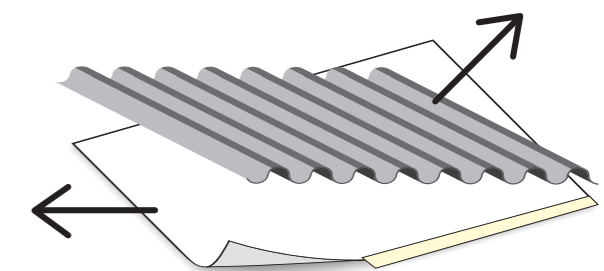



Emilceramica S.r.l. a socio unico	Sede Commerciale/Amministrativa
emilgroup.it	Via Ghiarola Nuova, 29 - 41042 Fiorano Modenese (Mo) Italy T +39 0536 835111 - info@emilceramicagroup.it